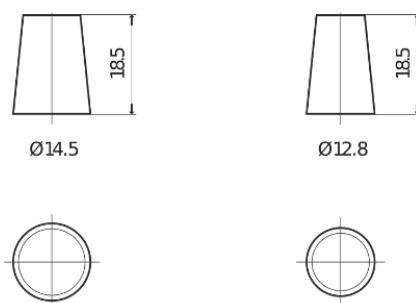

Product overview

Batteries for Cars

Excell EB356A

| | |
|--------------------------------|----------------|
| Part number | EB356A |
| Technology | Flooded |
| EAN/GTIN | 3661024034883 |
| Voltage | 12 V |
| Capacity | 35.0 Ah |
| CCA | 240 A |
| Length | 187 mm |
| Width | 127 mm |
| Height | 220 mm |
| Box size | B19 |
| Polarity | ETN 0 |
| Terminal Type | JIS taper post |
| Hold Down | Korean B1 Long |
| Weights (subject of variation) | 8.90 kg |

Polarity**Terminal Type**

Positive Terminal

Negative Terminal

Hold Down

Design, features and specifications are subject to change without notice. We disclaim any representation or warranty, express or implied, concerning the data or recommendations, and in no event shall be liable for any loss or damage claimed to have arisen as a result. Some products may not be available in your local market.