



## Product overview

# TUDOR®

Batteries for Trucks, Buses, Construction, Agriculture

## StartPRO TG1705



Part number	TG1705
Technology	Flooded
EAN/GTIN	3661024055536
Voltage	12 V
Capacity	170 Ah
CCA	950 A
Length	514 mm
Width	218 mm
Height	210 mm
Box size	DB9
Polarity	ETN 3
Terminal Type	EN taper post
Hold Down	B3
Weights (subject of variation)	42.50 kg

### Polarity

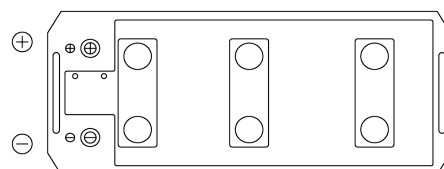

### Terminal Type

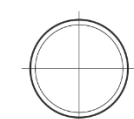
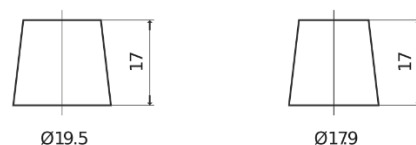

Positive Terminal

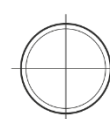

Negative Terminal

### Hold Down



Design, features and specifications are subject to change without notice. We disclaim any representation or warranty, express or implied, concerning the data or recommendations, and in no event shall be liable for any loss or damage claimed to have arisen as a result. Some products may not be available in your local market.